

SUBJECT: ARDF Original misfeed.

DATE:

Mar. 15, 1993

PAGE: 1 of 2

PREPARED BY: N. Takai/M. Furusawa

FROM: Copier Technical Support Section

CHECKED BY:

CLASSIFICATION:

☐ Action Required

☒ Troubleshooting

☐ Retrofit Information

☐ Revision of service manual

☐ Information only

☐ Other

MODEL:

N440 Series

(A085/A087/A088)

Symptom:

Original misfeed occurs intermittently.

Possible Cause:

1. The DF registration sensor is activated by paper dust on the sensor pad, affecting its color.
2. When the original feed roller starts rotating, the DF upper guide plate is warped slightly downward. The clearance between the DF registration sensor and the sensor pad is reduced. When this happens, the DF registration sensor (reflective type) can receive the reflective light from the sensor pad, even though its color is black.

Action Required:

(For cause 1)

1. Open the feed-in unit [A].
2. Clean the DF registration sensor surface [B] and the sensor pad [C].

NOTE: To remove the paper dust from the sensor pad, it is better to use scotch tape.

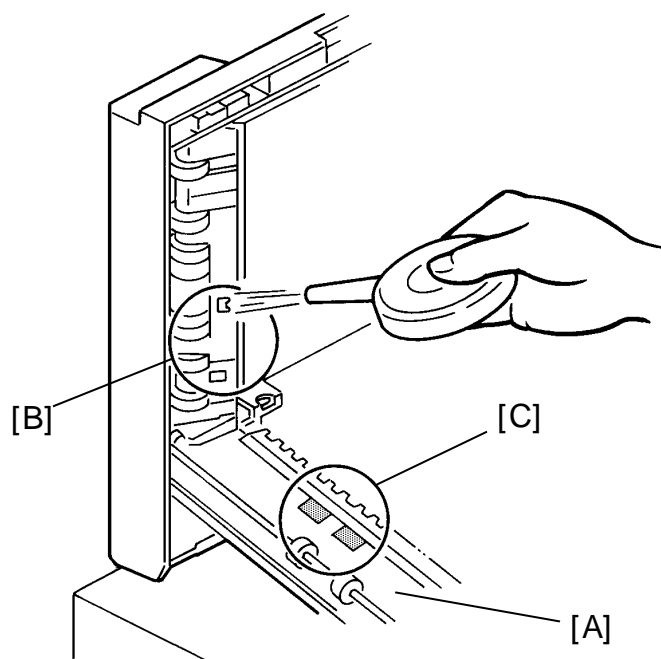

SUBJECT: ARDF Original misfeed.

DATE:

Mar. 15, 1993

PAGE: 2 of 2

(For cause 2)

1. Remove the two screws of the pull out hinge [D].
2. Insert 2 pcs each of 0.8 mm spacer (P/No. 07010040) and fix the screws. [E].
 - This can give the registration sensor enough clearance for the sensor pad.

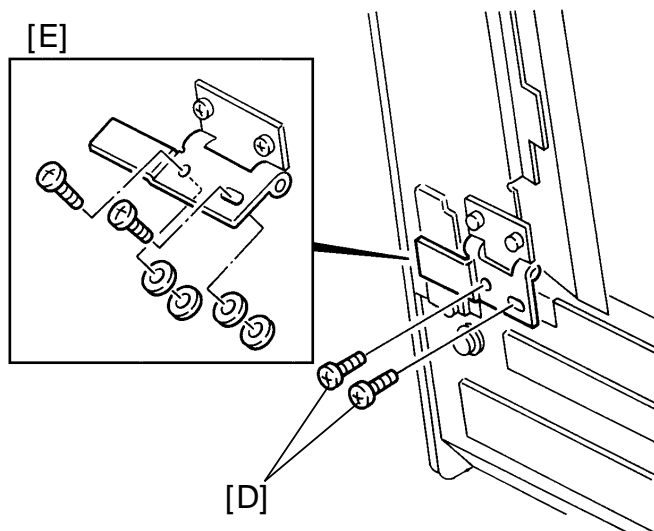
**Permanent Countermeasure:**

The shape of the pull out bracket (P/No. A4651057) will be modified so that the sensor pad is positioned 1.5 mm further from the DF registration sensor.

Soon after the modification is applied to the production, an M/B will be issued.